

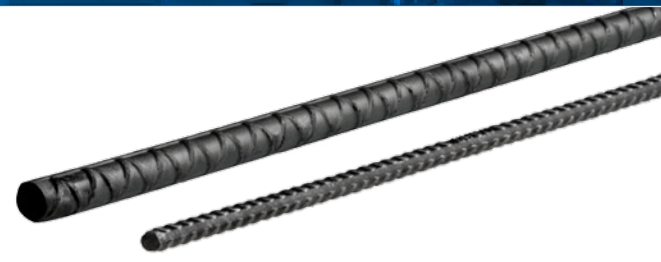

**serviacero**  
comercial

• Rebar



Rebar R-42 / Rebar High Strength R-6000						
Size	Nominal diameter		Area en cm <sup>2</sup>	Perimeter in cm	kg x ml	pieces per ton (aprox)
	mm	inche				
**-	--	5/32	0.12	--	0.100	1666
**-	--	3/16	0.18	--	0.133	1253
**-	--	1/4	0.32	--	0.250	667
**-	--	5/16	0.49	--	0.384	434
*2.5	7.9	5/16	0.49	2.48	0.384	217
*3	9.5	3/8	0.71	2.98	0.557	150
*4	12.7	1/2	1.27	3.99	0.996	84
*5	15.9	5/8	1.99	5.00	1.580	53
*6	19.1	3/4	2.87	6.00	2.250	37
*8	25.4	1	5.07	7.98	3.975	21
*10	31.8	1 1/4	7.94	9.99	6.225	13
*12	38.1	1 1/2	11.4	11.97	8.938	9
**	R-6000					
*	R-42					

Mechanical Properties of Tension (R-42)	
Tensile strength (minimum)	6,300 kg/cm <sup>2</sup>
Yield point (minimum)	4,200 kg/cm <sup>2</sup>
Minimum elongation in 200 mm:	
3/8, 1/2, 5/8, 3/4	9%
1	8%
1 1/4, 1 1/2	7%

Mechanical Properties of Bending (R-42)	
Rebar	Bent at 180 ° Chuck Diameter
3/8, 1/2, 5/8	3.5 d
3/4, 1	5.0 d
1 1/4	7.0 d
1	8%
d = Nominal diameter of the test tube	

At room temperature (16 ° minimum) under the following conditions:

Using of the right chuck

Applying a continuous and uniform force

Keeping the product and chuck together during bending

